

Temperature Regulation Quick Connect Couplings

plug size 13.5 mm – High Resistant Special Brass **Series ESDT**
with Automatic Locking Mechanism

- Forced guidance design with visual colour coding at the locking sleeve
- Combined pressure-torsion spring and very robust locking sleeve made of high resistance special brass
- For temperature regulation applications with hot or cold water as well as tempered oil
- Optionally available with straight-through, single or double shut-off
- Versions with additional O-ring sealing at connection port to prevent leakage in high temperature applications

Materials

- Body, valve body, valve, plug: Brass MS 58 plain
- Sleeve: High resistant special brass plain/ nickel-plated
- Spring, retaining ring: Stainless steel 1.4310
- Balls: Stainless steel 1.4034
- O-Rings: Special-Hitec-FKM-O-ring

Max. Working Pressure	Temperature	DN	Thread	Operation	Type of valve	Media	
PN 15 bar	-20°C – +200°C*	9	ISO 288/ DIN 13	One-hand	single/double/straight-thr.	Tempered media	5

Couplings with hose connection

Couplings with straight standard hose stem without/with valve

Hose connection	L	D	L1	DS	Passage	Weight	Type No. w/o valve	Type No. w valve
Hose i.D. 13	64.5	24	25	13.5	9	94	ESDT 13 TL	ESDT 13 TLAB

Couplings with 45° standard hose stem without/with valve

Hose connection	L	D	L1	DS	Passage	Weight	Type No. w/o valve	Type No. w valve
Hose i.D. 13	57	24	25	13.5	9	147	ESDT 13 TL45	ESDT 13 TL45AB

Couplings with 90° standard hose stem without/with valve

Hose connection	L	D	L1	DS	Passage	Weight	Type No. w/o valve	Type No. w valve
Hose i.D. 13	57	24	25	13.5	9	149	ESDT 13 TL90	ESDT 13 TL90AB

Couplings with male threads

Couplings with straight male thread without/with valve (inner cone DIN 3863)

Thread connect.	L	SW	D	L1	DS	Passage	Weight	Type No. w/o valve	Type No. w valve
G 3/8 m	57.5	22	24	12.5	13.5	9	108	ESDT38AL	ESDT38ALAB
M 16x1.5 m	57.5	22	24	12.5	13.5	9	107	ESDT1615AL	ESDT1615ALAB

Couplings with 45° male thread without/with valve (inner cone DIN 3863)

Thread connect.	L	SW	D	L1	DS	Passage	Weight	Type No. w/o valve	Type No. w valve
G 3/8 m	57	22	24	12.5	13.5	9	144	ESDT38AL45	ESDT38AL45AB
M 16x1.5 m	57	22	24	12.5	13.5	9	140	ESDT1615AL45	ESDT1615AL45AB

Couplings with 90° male thread without/with valve (inner cone DIN 3863)

Thread connect.	L	SW	D	L1	DS	Passage	Weight	Type No. w/o valve	Type No. w valve
G 3/8 m	57	22	24	12.5	13.5	9	146	ESDT38AL90	ESDT38AL90AB
M 16x1.5 m	57	22	24	12.5	13.5	9	143	ESDT1615AL90	ESDT1615AL90AB

Other types / sizes on request!

DN 9

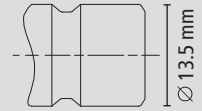

Plug Profile (original size)

Temp Secure
by **LUDECKE**



International
Plug Profile

