

TIMER CONTROLLED CONDENSATE DRAIN - TD16

DESCRIPTION

TD16 timer controlled condensate drain has been developed for reliable removal of condensate or other liquid from compressed air system⁽¹⁾. Discharge intervals can be set with two adjustment knobs.

APPLICATIONS⁽²⁾

- Air Compressor (piston or screw)
- After-cooler
- Cyclone condensate separator
- Pressure vessel/Air tank
- Air dryer
- Air filter



⁽¹⁾ For any other technical gas please contact us or your local dealer

⁽²⁾ TD16 can be used in variety of applications. For applications not listed please contact us or your local dealer.

TECHNICAL SPECIFICATION⁽³⁾

Operating temperature	1,5 - 65 °C	35 - 149 °F
Operating pressure (Standard version)	0 - 16 bar(g)	0 - 232 psi
Protection class	IP54	
Supply voltage	115V / 230V (±10%), AC, 50/60Hz	
Coil power	18VA (holding), 36 (inrush)	
Cable dimensions	3 x 0,75mm ²	
Mass	0,35	
Input connection	R1/2"	
Output connection	Ø8/6mm (hose) or R1/8"	
Valve	Solenoid valve, Normally closed	
Time ON	0,5s - 10s	
Time OFF	0,5min - 45min	
Indicator	LED light "Green-Power ON, Orange-Valve open"	
Max Capacity ⁽³⁾	95 l/h	

⁽³⁾ Standard version, at 7 barg

MATERIALS⁽⁵⁾

Housing material	PA6, 30% glass fibre
Screws	Plastic
Coil	Steel, Copper
Valve	Stainless Steel
Housing sealing	NBR
Valve sealing	FKM

⁽⁵⁾ Standard version

DIMENSIONS

A	92 mm
B	68 mm
C	97 mm

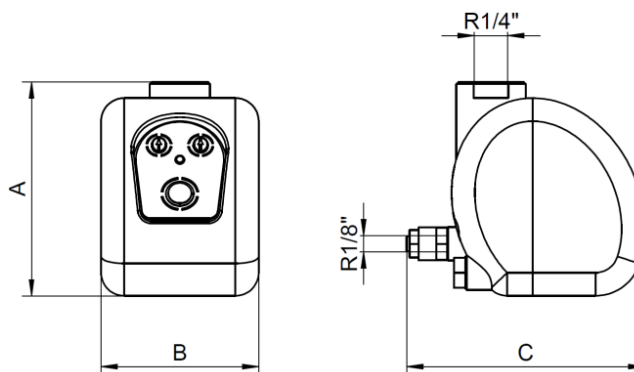

TYPES

Model	Power supply	Frequency	Power	Protection	Cable	Flow rate Kvs [l/min]
TD16 115VAC	115V ±10%	50-60 Hz	18W	IP54	3x0,75mm ²	2,4
TD16 230 VAC	230V ±10%	50-60 Hz	18W	IP54	3x0,75mm ²	2,4

APPROXIMATE CALCULATION OF DISCHARGE CAPACITY

$$Q = Kvs \times \sqrt{\Delta p} \times t$$

Q-Discharge capacity [l/min], Kvs-Flow coefficient, Δp-pressure difference [bar], t-duration of valve being opened [min]

MAINTENANCE

If necessary disassemble and clean the valve. Once per year make a visual check of the drain and make sure there is no visual damage or leakage.

Condensate discharged from compressed air system contains significant amounts of lubricant oil. We strongly recommend connecting TD16 to oil water separator. In most countries content of oil in waste water is regulated by law.

INFORMATION IN THIS DOCUMENT IS SUBJECT TO CHANGE WITHOUT NOTICE

	<p>Our quality management system is certified by BUREAU VERITAS in conformity with ISO 9001:2008 Reg. number: 200285</p>	
---	--	--